

Casings & Baseboards

WOOD PRODUCTS
2 Wood Moldings

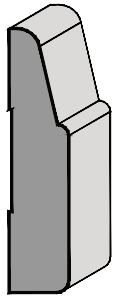

J1126
 $\frac{5}{8}'' \times 2\frac{3}{4}''$
 (15.8 x 69.90mm)

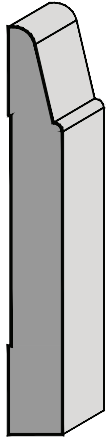

J1125
 $\frac{9}{16}'' \times 4\frac{1}{4}''$
 (14.3 x 108mm)

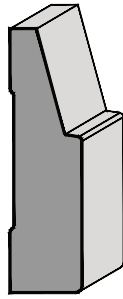

J1488
 $\frac{3}{4}'' \times 2\frac{3}{4}''$
 (19.1 x 69.9mm)

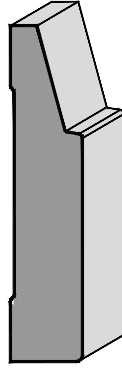

J1489
 $\frac{3}{4}'' \times 3\frac{1}{2}''$
 (19.1 x 88.9mm)



J170
 $\frac{1}{2}'' \times 5\frac{1}{4}''$
 (13 x 133.4mm)

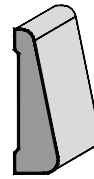

***J616**
 $\frac{7}{16}'' \times 1\frac{1}{2}''$
 (11.5 x 38.1mm)

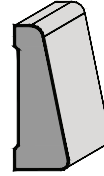

J1280
 $\frac{9}{16}'' \times 1\frac{1}{2}''$
 (14.3 x 38.1mm)

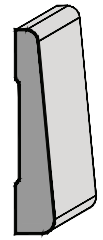

J606
 $\frac{7}{16}'' \times 2\frac{1}{8}''$
 (10.4 x 54mm)

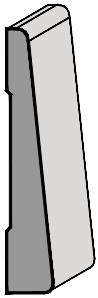

J1281
 $\frac{1}{2}'' \times 2\frac{3}{4}''$
 (12.3 x 69.9mm)

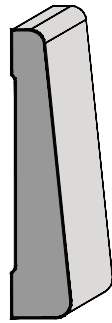

J644
 $\frac{5}{8}'' \times 3''$
 (15.9 x 76.2mm)

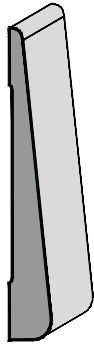

J615
 $\frac{7}{16}'' \times 3\frac{1}{4}''$
 (11.1 x 82.6mm)

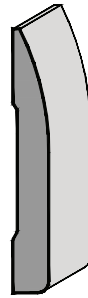

J607
 $\frac{3}{8}'' \times 2\frac{3}{4}''$
 (9.5 x 69.9mm)

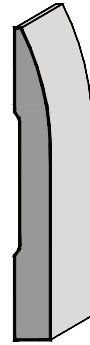

J632
 $\frac{3}{8}'' \times 3\frac{1}{4}''$
 (9.5 x 82.6mm)

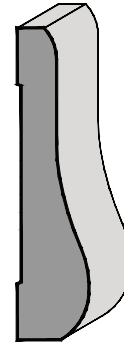

J1054
 $\frac{3}{4}'' \times 3\frac{1}{4}''$
 (19.1 x 82.6mm)

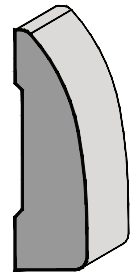

J627
 $\frac{3}{4}'' \times 2\frac{1}{2}''$
 (19.1 x 63.5mm)

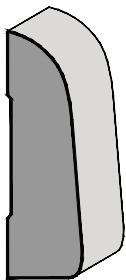

J1206
 $\frac{3}{4}'' \times 2\frac{9}{16}''$
 (19.8 x 65.3mm)

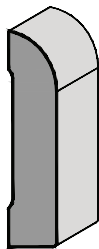

J628
 $\frac{1}{2}'' \times 2\frac{1}{4}''$
 (12.7 x 57.2mm)

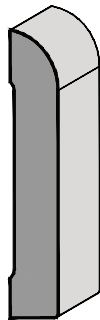

J629
 $\frac{1}{2}'' \times 3''$
 (12.7 x 76.2mm)

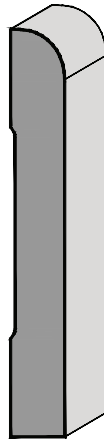

J631
 $\frac{9}{16}'' \times 4\frac{1}{4}''$
 (14.3 x 108mm)

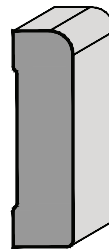

J1623
 $\frac{5}{8}'' \times 2\frac{1}{4}''$
 (15.9 x 57.2mm)

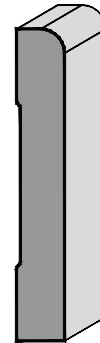

J1624
 $\frac{1}{2}'' \times 3\frac{1}{4}''$
 (12.7 x 82.6mm)

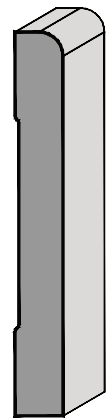

J1625
 $\frac{1}{2}'' \times 4''$
 (12.7 x 101.6mm)

WOOD PRODUCTS
WOOD MOLDINGS - Casing and Baseboard Molding

2 WOOD PRODUCTS
 Wood Moldings

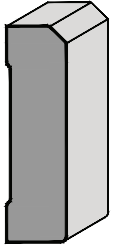

J1617
 $\frac{5}{8}$ "x $2\frac{1}{4}$ "
 (15.9 x 57.2mm)

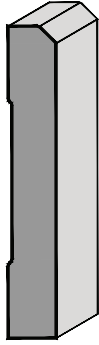

J1618
 $\frac{1}{2}$ "x $3\frac{1}{4}$ "
 (12.7 x 82.6mm)



J1619
 $\frac{1}{2}$ "x 4 "
 (12.7 x 101.6mm)



J1332
 $\frac{1}{2}$ "x 3 "
 (12.7 x 76.2mm)

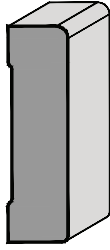

***J1620**
 $\frac{5}{8}$ "x $2\frac{1}{4}$ "
 (15.9 x 57.2mm)

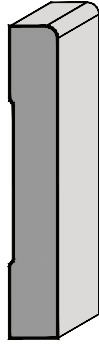

***J1621**
 $\frac{1}{2}$ "x $3\frac{1}{4}$ "
 (12.7 x 82.6mm)

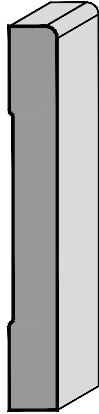

***J1622**
 $\frac{1}{2}$ "x 4 "
 (12.7 x 101.6mm)

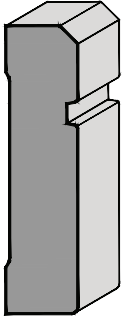

J1199
 $\frac{3}{4}$ "x 3 "
 (19.1 x 76.2mm)

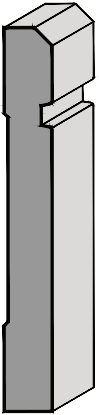

J1198
 $\frac{1}{2}$ "x 4 "
 (12.7 x 101.6mm)



***J659**
 $\frac{5}{8}$ "x $3\frac{15}{16}$ "
 (15.8 x 100.5mm)

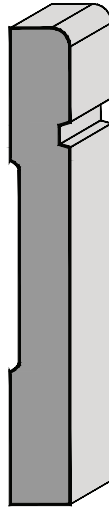

***J658**
 $\frac{5}{8}$ "x $4\frac{15}{16}$ "
 (15.8 x 126.2mm)

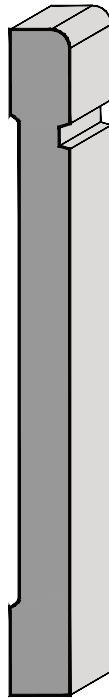

***J657**
 $\frac{5}{8}$ "x $6\frac{15}{16}$ "
 (15.8 x 176.2mm)

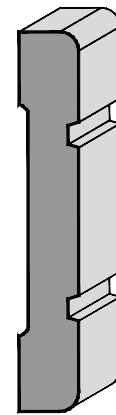

***J1141**
 $\frac{5}{8}$ "x $3\frac{15}{16}$ "
 (15.8 x 100.5mm)

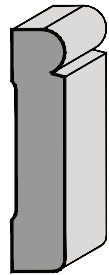

J1049
 $\frac{9}{16}$ "x $2\frac{1}{2}$ "
 (14 x 64mm)

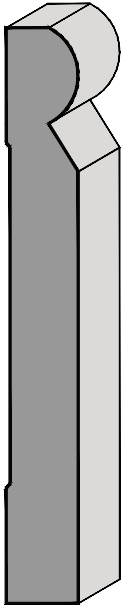

J577
 $\frac{3}{4}$ "x 6 "
 (19.1 x 152.4mm)



J1213
 $\frac{1}{2}$ "x 3 "
 (12.7 x 76.2mm)

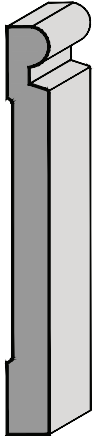

J1214
 $\frac{7}{16}$ "x $4\frac{1}{4}$ "
 (11.1 x 108mm)

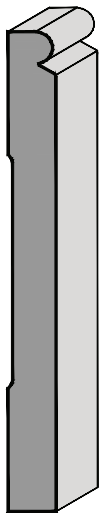

J1341
 $\frac{1}{2}$ "x 5 "
 (12.7 x 127mm)

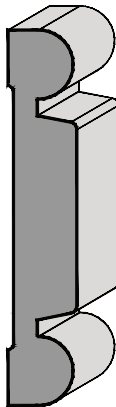

J855
 $\frac{11}{16}$ "x $3\frac{15}{16}$ "
 (18.3 x 99.4mm)



J857
 $\frac{11}{16}$ "x 5 "
 (17.5 x 127mm)

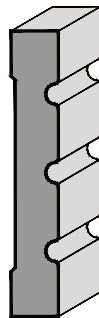

J880
 $\frac{1}{2}$ "x 3 "
 (12.5 x 75.6mm)

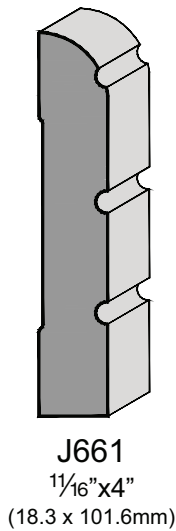

J661

1 1/16" x 4"
(18.3 x 101.6mm)

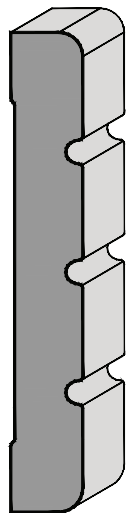

J864

3/4" x 5"
(19.1 x 127mm)

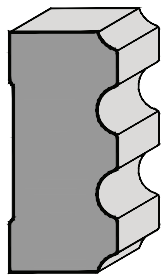

J591

1 1/8" x 2 1/2"
(28.6 x 63.5mm)

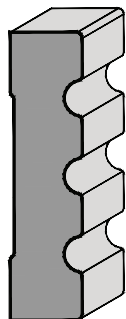

J1504

3/4" x 3"
(19.1 x 76.2mm)

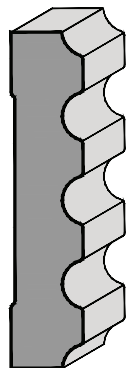

J854

3/4" x 3 1/2"
(19.1 x 88.9mm)

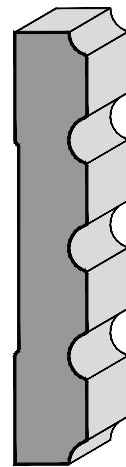

J718

3/4" x 4 1/2"
(19.1 x 114.3mm)

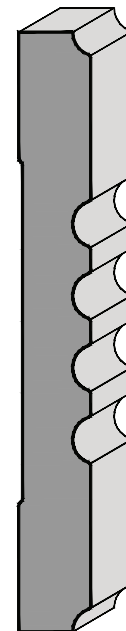

J719

3/4" x 6 1/4"
(19.1 x 158.7mm)

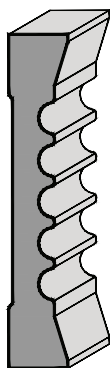

J867

5/8" x 3 1/2"
(15.7 x 88.4mm)

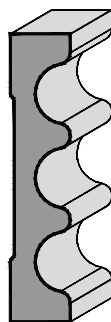

J007

5/8" x 3"
(15.9 x 76.8mm)

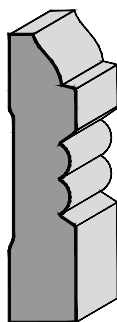

J1164

1 1/16" x 3"
(17.6 x 76.2mm)

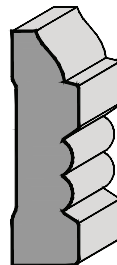

J1165

1 1/16" x 2 7/16"
(17.6 x 62mm)

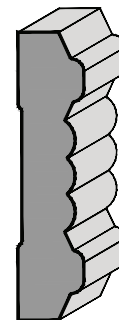

J1435

1 1/16" x 3"
(17.5 x 76.2mm)

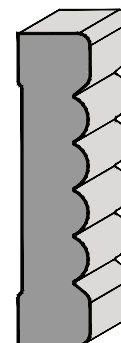

J1487

3/4" x 3 1/4"
(19.1 x 82.6mm)

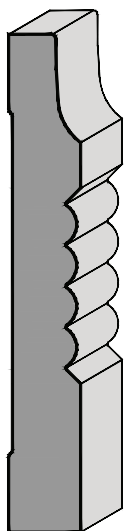

J624

3/4" x 5 3/16"
(19.1 x 131.8mm)

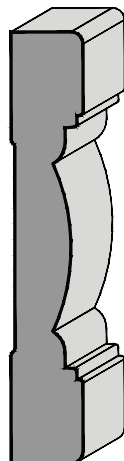

J988

3/4" x 4 1/2"
(19.1 x 114.3mm)

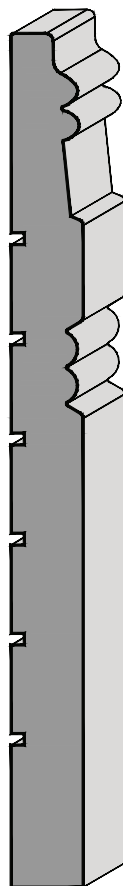

J656

3/4" x 8 7/8"
(19.1 x 225.4mm)

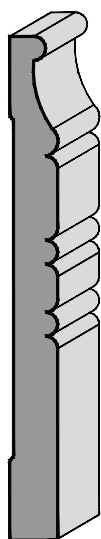

J027

1/2" x 5 1/4"
(12.7 x 133.4mm)

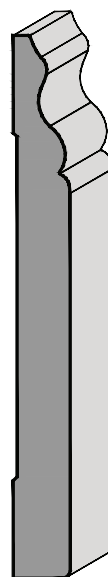

J621

9/16" x 5 5/8"
(15.1 x 143.7mm)

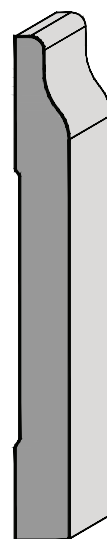

J016

9/16" x 5 1/4"
(14.3 x 133.4mm)

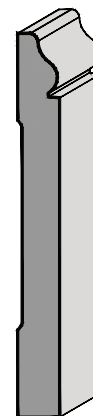

J1395

7/16" x 4"
(11.1 x 101.6mm)

WOOD PRODUCTS
WOOD MOLDINGS - Casing and Baseboard Molding

2 WOOD PRODUCTS
 Wood Moldings

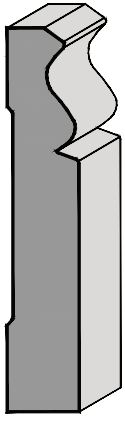

J626
 $\frac{3}{4}" \times 4"$
 (19.1 x 101.6mm)

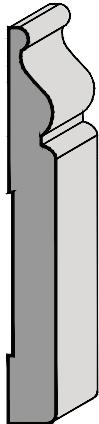

J194
 $\frac{1}{2}" \times 4\frac{1}{8}"$
 (12.7 x 104.8mm)

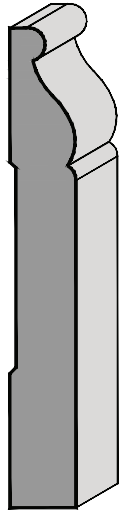

J363
 $1\frac{1}{16}" \times 5"$
 (17.5 x 127mm)

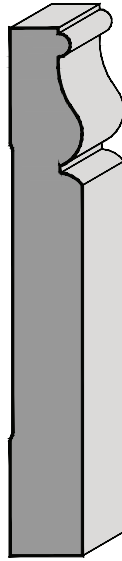

J686
 $\frac{3}{4}" \times 5\frac{1}{2}"$
 (19.2 x 139.7mm)

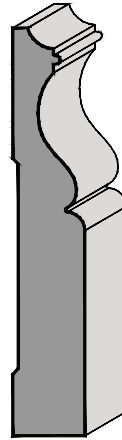

J625
 $\frac{3}{4}" \times 4\frac{1}{4}"$
 (19.1 x 108mm)

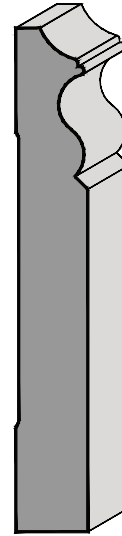

J1313
 $\frac{3}{4}" \times 5\frac{1}{4}"$
 (19.1 x 133.4mm)

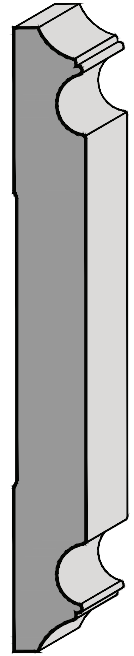

J1314
 $\frac{3}{4}" \times 6\frac{1}{2}"$
 (19.1 x 165.1mm)

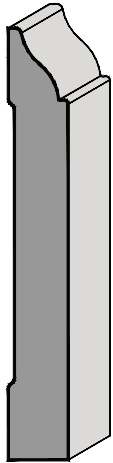

***J1128**
 $\frac{5}{8}" \times 4\frac{1}{2}"$
 (15.9 x 114.3mm)



***J623**
 $\frac{7}{16}" \times 3\frac{1}{4}"$
 (11.1 x 82.6mm)

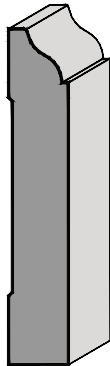

J1115
 $\frac{5}{8}" \times 3\frac{1}{2}"$
 (15.9 x 88.9mm)

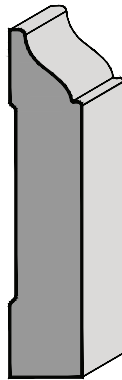

J959
 $\frac{3}{4}" \times 3\frac{5}{8}"$
 (19.1 x 92mm)

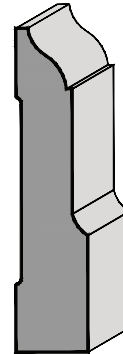

J251
 $\frac{3}{4}" \times 3\frac{3}{8}"$
 (19.1 x 85.7mm)

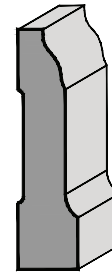

J252
 $\frac{5}{8}" \times 2\frac{1}{2}"$
 (15.9 x 63.5mm)

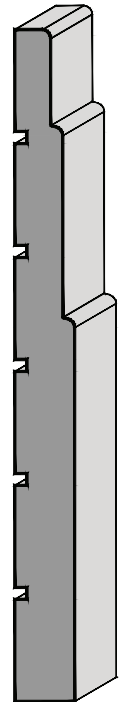

J1407
 $\frac{5}{8}" \times 7"$
 (15.9 x 177.8mm)

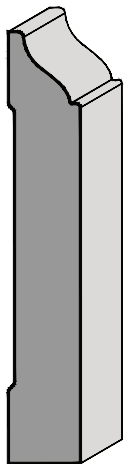

J958
 $\frac{3}{4}" \times 4\frac{1}{2}"$
 (19.1 x 114.3mm)

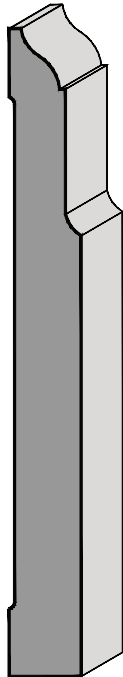

J254
 $\frac{3}{4}" \times 6\frac{3}{4}"$
 (19.1 x 171.5mm)

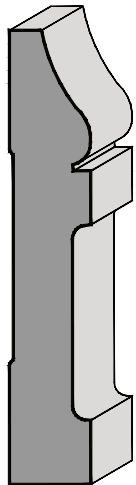

J064
 $\frac{7}{8}" \times 4\frac{3}{4}"$
 (21.5 x 120.2mm)



J044
 $\frac{3}{4}" \times 4"$
 (19.1 x 101.6mm)

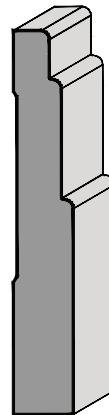

J1406
 $\frac{5}{8}" \times 4"$
 (15.9 x 101.6mm)

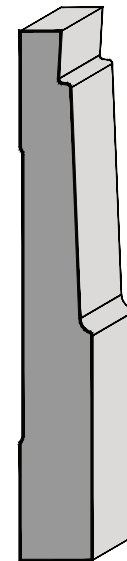

J1091
 $\frac{3}{4}" \times 5\frac{1}{2}"$
 (19.1 x 140.1mm)

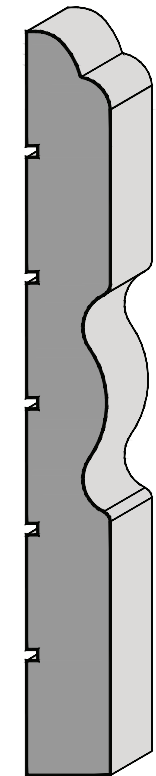

J1538
7/8" x 7 3/4"
(22.2 x 196.9mm)

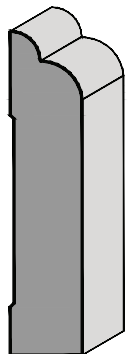

J1379
3/4" x 3 3/8"
(19.1 x 85.7mm)

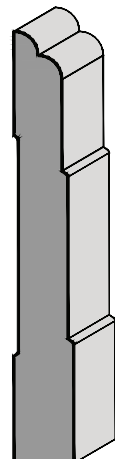

J983
5/8" x 4 1/2"
(15.9 x 114.3mm)

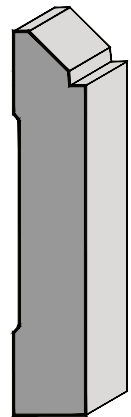

J1034
3/4" x 4"
(19.1 x 101.6mm)

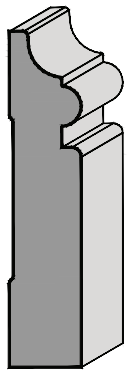

J649
3/4" x 3 1/2"
(19.1 x 88.9mm)

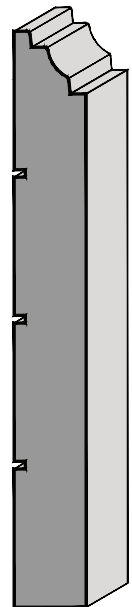

J1197
3/4" x 6"
(19.1 x 152.4mm)

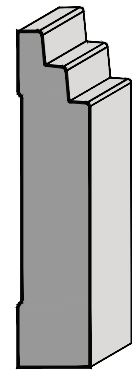

J1502
3/4" x 3 1/2"
(19.1 x 88.9mm)

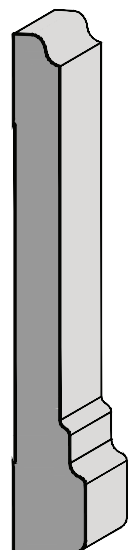

J662
3/4" x 5 7/16"
(19.1 x 137.4mm)

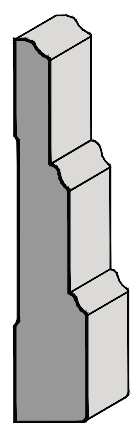

J1152
3/4" x 4"
(19.1 x 101.4mm)

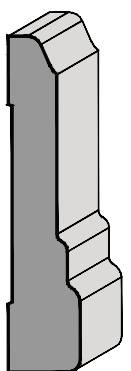

J612
3/4" x 3 1/2"
(19.1 x 88.9mm)

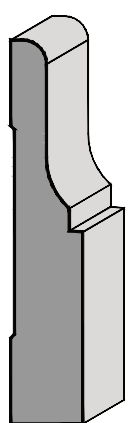

J1203
3/4" x 4"
(19.1 x 101.6mm)

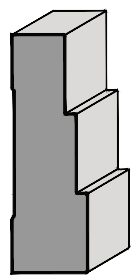

J052
13/16" x 2 1/2"
(20 x 63mm)

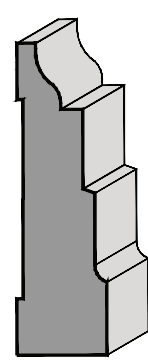

J020
15/16" x 3 1/4"
(23.8 x 82.6mm)

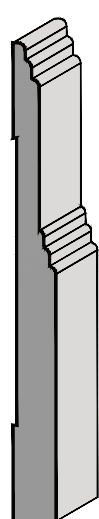

J639
7/16" x 5"
(11.4 x 126.7mm)

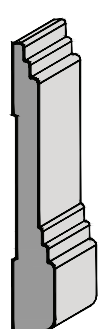

J611
7/16" x 3"
(11.1 x 76.2mm)

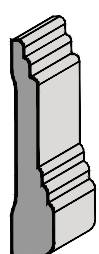

J608
7/16" x 2 1/4"
(11.1 x 57.2mm)

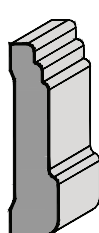

J620
1/2" x 2"
(12.7 x 50.8mm)

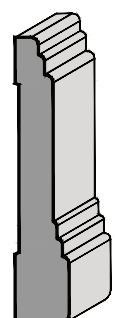

J610
9/16" x 3"
(14.3 x 76.2mm)

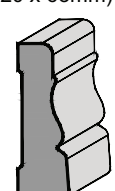

J617
1/2" x 1 5/8"
(13.5 x 41.3mm)

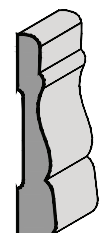

***J622**
7/16" x 2 1/8"
(10.4 x 54mm)

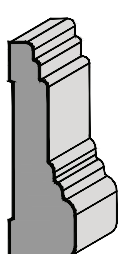

J609
1 1/16" x 2 1/4"
(17.5 x 57.2mm)

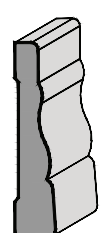

J1200
7/16" x 2"
(10.8 x 51.6mm)

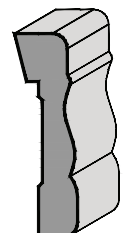

J1009
5/8" x 2 1/8"
(16.7 x 54mm)

WOOD PRODUCTS
WOOD MOLDINGS - Casing and Baseboard Molding

2 WOOD PRODUCTS
 Wood Moldings

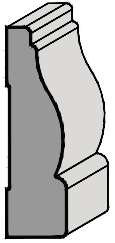

J053
 $\frac{5}{8}'' \times 2\frac{3}{16}''$
 (15.9 x 55.6mm)

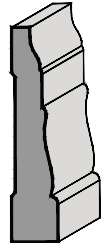

J899
 $\frac{1}{2}'' \times 2\frac{1}{4}''$
 (12.3 x 56.8mm)

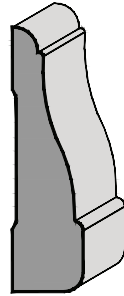

J642
 $\frac{3}{4}'' \times 2\frac{3}{4}''$
 (18.7 x 70mm)

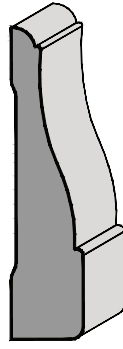

J663
 $\frac{3}{4}'' \times 3\frac{1}{4}''$
 (19.1 x 82.6mm)

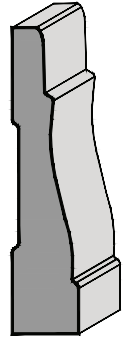

J076
 $1\frac{1}{16}'' \times 3\frac{3}{16}''$
 (17.6 x 81.1mm)

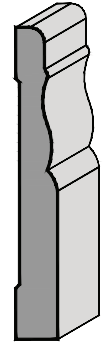

***J630**
 $\frac{7}{16}'' \times 3\frac{1}{4}''$
 (11.1 x 82.6mm)

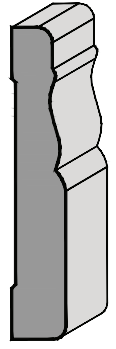

J1296
 $\frac{9}{16}'' \times 3\frac{1}{4}''$
 (14.3 x 82.6mm)

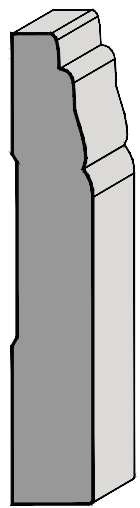

J640
 $1\frac{3}{16}'' \times 4\frac{7}{8}''$
 (21.3 x 124.5mm)

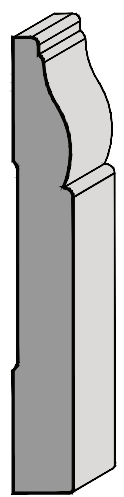

J641
 $\frac{5}{8}'' \times 4\frac{3}{4}''$
 (15.9 x 120.6mm)

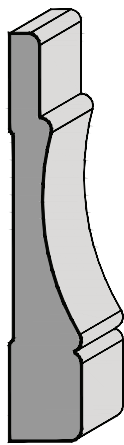

J051
 $\frac{3}{4}'' \times 4\frac{1}{4}''$
 (19.1 x 108mm)

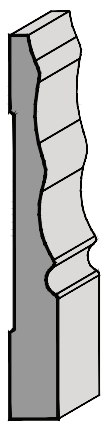

J648
 $\frac{1}{2}'' \times 4''$
 (12.7 x 101.6mm)

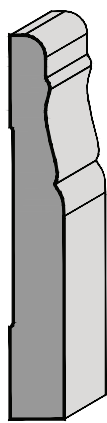

J1297
 $\frac{9}{16}'' \times 4''$
 (14.3 x 101.6mm)

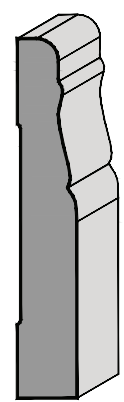

J665
 $\frac{5}{8}'' \times 3\frac{3}{4}''$
 (15.9 x 95.3mm)

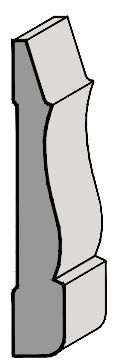

J100
 $\frac{9}{16}'' \times 3\frac{5}{16}''$
 (13.6 x 83.5mm)

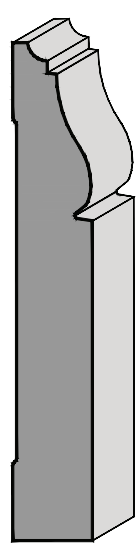

J645
 $1\frac{3}{16}'' \times 5\frac{3}{16}''$
 (21.1 x 131.8mm)

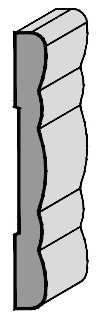

J614
 $\frac{5}{16}'' \times 2\frac{7}{8}''$
 (8.2 x 73mm)

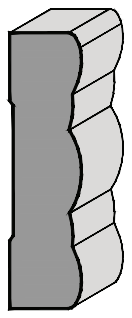

J876
 $\frac{3}{4}'' \times 2\frac{7}{8}''$
 (19.1 x 73mm)

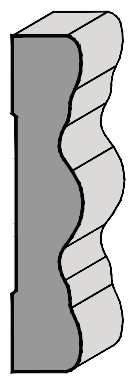

J853
 $1\frac{1}{16}'' \times 3\frac{1}{2}''$
 (18.3 x 88.9mm)

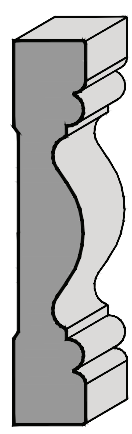

J084
 $\frac{3}{4}'' \times 4''$
 (19.1 x 101.6mm)

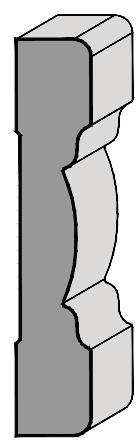

J1056
 $\frac{3}{4}'' \times 4\frac{1}{8}''$
 (19.8 x 105mm)

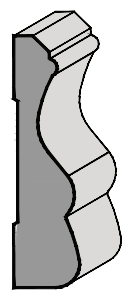

***J604**
 $1\frac{1}{16}'' \times 2\frac{5}{8}''$
 (17.5 x 66.7mm)

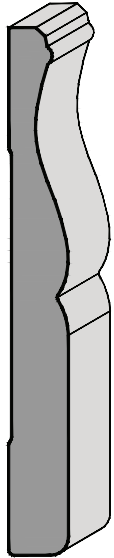

J619
5/8" x 5 1/2"
(15.9 x 139.7mm)

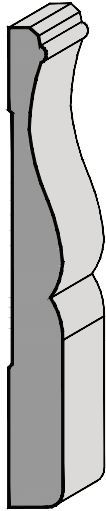

J618
9/16" x 5"
(14.3 x 127mm)

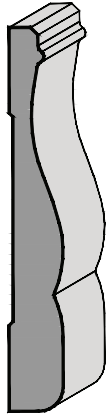

***J605**
9/16" x 4"
(14.3 x 101.6mm)

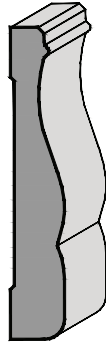

J444
9/16" x 3 1/4"
(14.3 x 82.6mm)

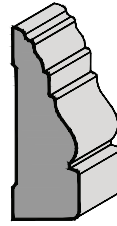

J638
1 1/16" x 2"
(17.5 x 50.8mm)

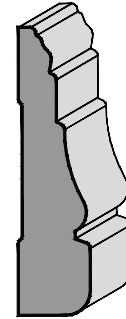

J1480
3/4" x 3"
(19.1 x 76.2mm)

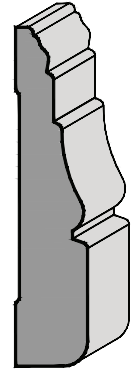

J660
3/4" x 3 1/2"
(19.1 x 89.7mm)

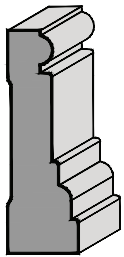

J1342
3/4" x 2 5/16"
(18.7 x 59mm)

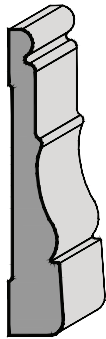

J065
9/16" x 3 3/16"
(14.4 x 81mm)

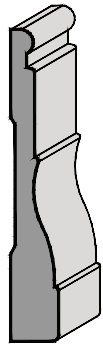

J1292
1/2" x 3 1/4"
(12.7 x 82.6mm)

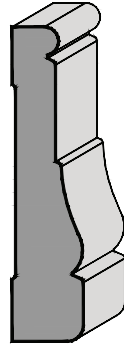

J643
3/4" x 3 1/4"
(18.9 x 83.2mm)

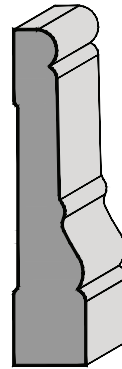

J1147
3/4" x 3 1/2"
(19.1 x 88.9mm)

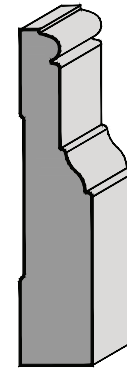

J1521
3/4" x 3 1/2"
(19.1 x 88.9mm)

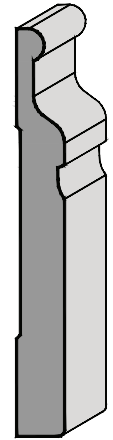

J1293
1/2" x 4 1/4"
(12.7 x 108mm)

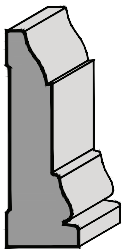

J652
3/4" x 2 1/4"
(19.1 x 57.2mm)

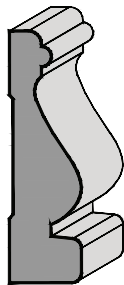

J1114
3/4" x 2 5/8"
(19.1 x 66.7mm)

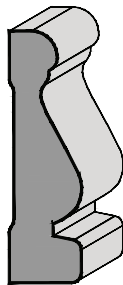

J249
3/4" x 2 5/8"
(19.1 x 66.7mm)

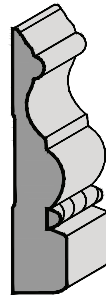

J978
9/16" x 2 3/4"
(14.3 x 69.9mm)

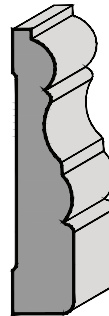

J1201
5/8" x 2 15/16"
(16.2 x 75.3mm)

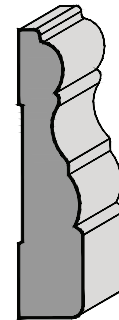

J583
1 1/16" x 3"
(17 x 76.2mm)

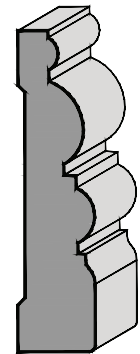

J650
1 3/16" x 3 3/8"
(20.5 x 85mm)

WOOD PRODUCTS
WOOD MOLDINGS - Casing and Baseboard Molding

2 WOOD PRODUCTS
Wood Moldings

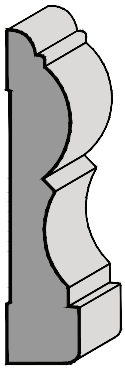

J523
 $\frac{3}{4}'' \times 3\frac{1}{2}''$
 (19.1 x 88.3mm)

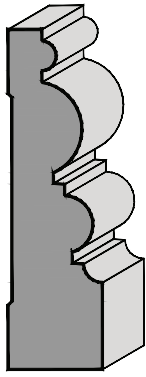

J541
 $1'' \times 3\frac{9}{16}''$
 (25 x 90mm)

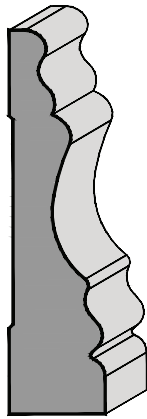

J593
 $1'' \times 4''$
 (25.4 x 101.6mm)

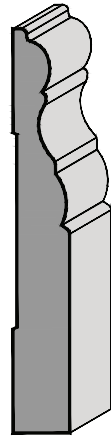

J582
 $\frac{9}{16}'' \times 4\frac{3}{16}''$
 (15 x 107mm)

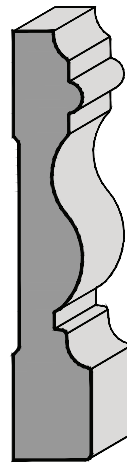

J1413
 $\frac{13}{16}'' \times 4\frac{7}{16}''$
 (20.6 x 113.5mm)

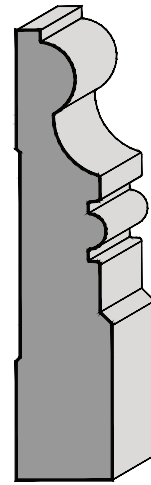

J1365
 $1'' \times 4\frac{1}{16}''$
 (25.4 x 119.1mm)

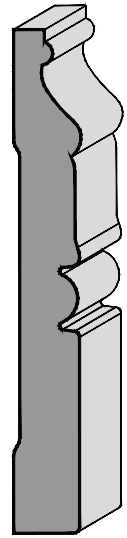

J083
 $\frac{1}{16}'' \times 5\frac{1}{4}''$
 (17.5 x 133.4mm)

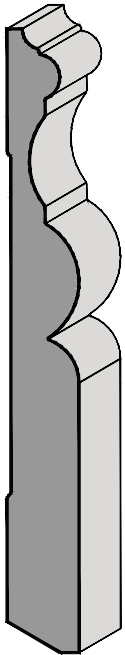

J1520
 $\frac{3}{4}'' \times 6\frac{1}{2}''$
 (19.1 x 165.1mm)

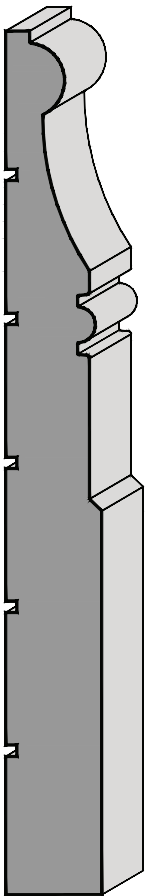

J1364
 $1'' \times 9''$
 (25.4 x 228.6mm)

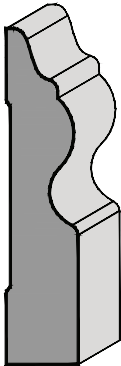

J1196
 $\frac{3}{4}'' \times 3\frac{1}{2}''$
 (19.1 x 88.9mm)

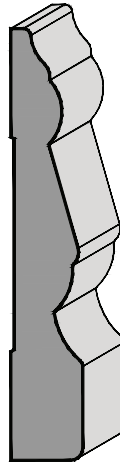

J1186
 $\frac{3}{4}'' \times 4\frac{1}{2}''$
 (19.1 x 114.3mm)

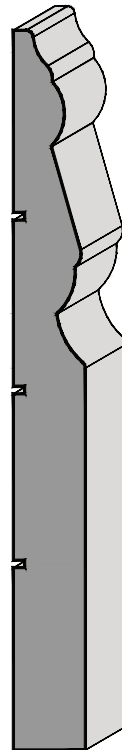

J1185
 $\frac{3}{4}'' \times 7\frac{1}{2}''$
 (19.1 x 190.5mm)

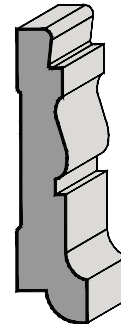

J184
 $\frac{3}{4}'' \times 3\frac{1}{16}''$
 (18.6 x 77.8mm)

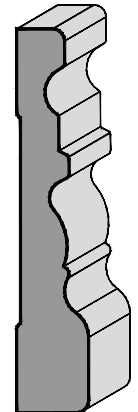

J1465
 $\frac{3}{4}'' \times 4''$
 (19.1 x 101.6mm)

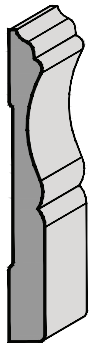

J1515
 $\frac{3}{8}'' \times 3\frac{1}{4}''$
 (9.5 x 82.6mm)

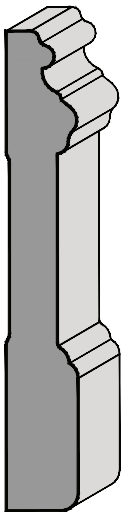

J071
 $\frac{3}{4}'' \times 5''$
 (19.1 x 127mm)

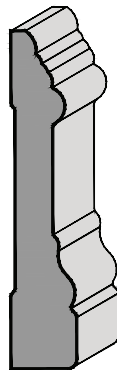

J1271
 $\frac{1}{16}'' \times 3\frac{1}{2}''$
 (17.5 x 89.5mm)

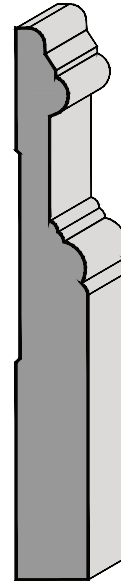

J596
 $\frac{3}{4}'' \times 5\frac{3}{4}''$
 (19.1 x 146.1mm)

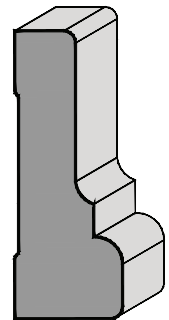

J193
 $1\frac{1}{8}'' \times 3''$
 (28.6 x 76.2mm)

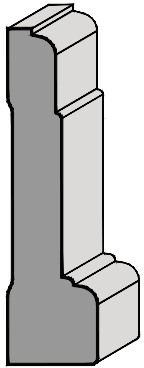

J1430
 $1\frac{5}{16}'' \times 3\frac{1}{2}''$
 (23.8 x 88.9mm)

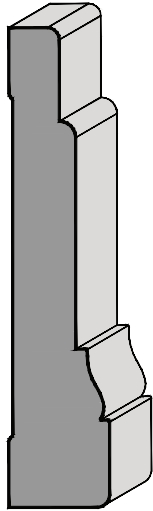

J186
 $1\frac{1}{16}'' \times 5''$
 (26.7 x 127mm)

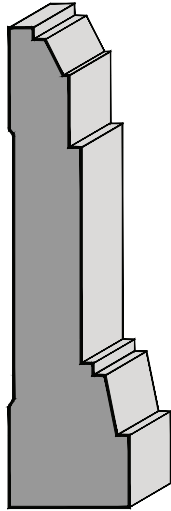

J365
 $1\frac{1}{4}'' \times 5''$
 (31.8 x 127mm)

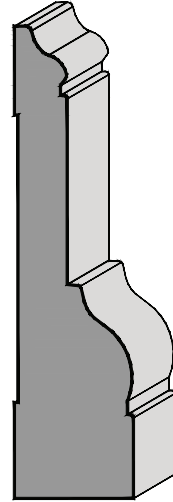

J599
 $1\frac{1}{4}'' \times 4\frac{15}{16}''$
 (31.5 x 125mm)

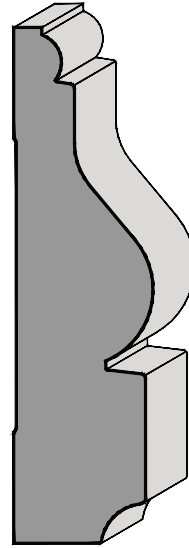

J1439
 $1\frac{7}{16}'' \times 5\frac{3}{8}''$
 (36.9 x 136.5mm)

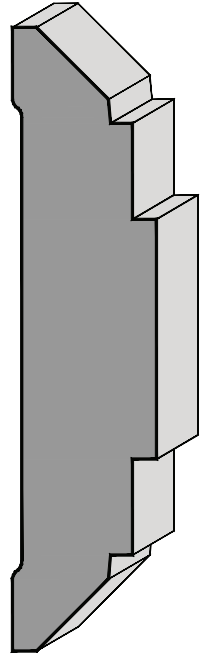

J1035
 $1\frac{1}{2}'' \times 6\frac{1}{2}''$
 (38.1 x 165.1mm)



J183
 $1\frac{3}{16}'' \times 7\frac{11}{16}''$
 (20.7 x 195.3mm)

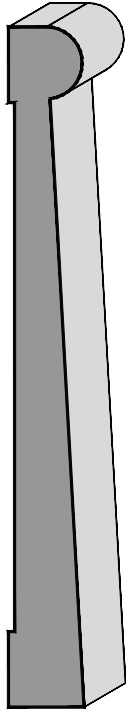

J033
 $1\frac{3}{16}'' \times 7\frac{1}{16}''$
 (20 x 180mm)

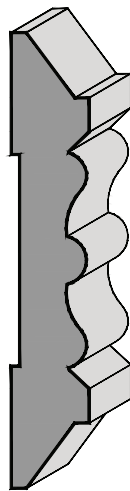

J856
 $1\frac{3}{16}'' \times 4\frac{3}{4}''$
 (20.6 x 120.7mm)

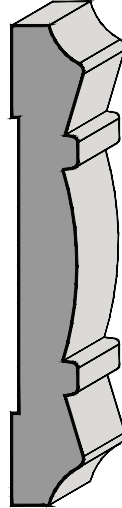

J862
 $\frac{3}{4}'' \times 5''$
 (19.1 x 127mm)

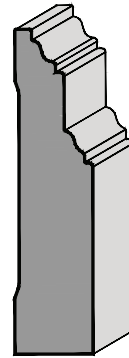

J646
 $1\frac{3}{16}'' \times 3\frac{3}{8}''$
 (20.6 x 85.7mm)

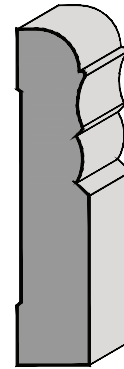

J1315
 $\frac{3}{4}'' \times 3\frac{1}{2}''$
 (19.1 x 88.9mm)

Scribe Molding

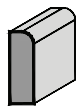

***J1450**
 $\frac{1}{4}'' \times 3\frac{3}{4}''$
 (6.4 x 19.1mm)

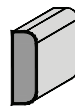

***J861**
 $\frac{1}{4}'' \times 3\frac{3}{4}''$
 (6.4 x 19.1mm)



J158
 $\frac{3}{8}'' \times 3\frac{3}{4}''$
 (9.5 x 19.1mm)

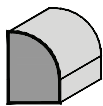

***J214**
 $\frac{9}{16}'' \times 3\frac{3}{4}''$
 (13.6 x 18.8mm)

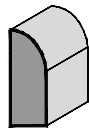

J188
 $\frac{3}{8}'' \times 1''$
 (9.5 x 25.4mm)



J042
 $\frac{5}{16}'' \times 1''$
 (7.9 x 25.4mm)



J288
 $\frac{1}{4}'' \times 1\frac{1}{4}''$
 (6.4 x 31.8mm)

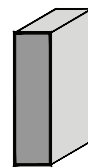

***J982**
 $\frac{3}{8}'' \times 1\frac{3}{8}''$
 (9.5 x 34.9mm)

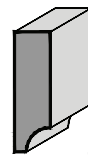

J240
 $\frac{3}{8}'' \times 1\frac{1}{4}''$
 (9.5 x 31.8mm)